



Accessories

300/425 Amp Series C (Aluminium)

Body Size C - 6600V

Ordering Procedure

- 1
- Select complete Accessory from Table 1

Table 1

Part Number	Description
F-4716A	300/425A Blanking Cover
3049	300A Phase Connecting Pin
3478	425A Phase Connecting Pin
3043	300/425A Pilot Connecting Pin
3766-1	Socket Extraction Tool
AH113157	Screw M12 x 40 hex. head
AH120012	Nut M12

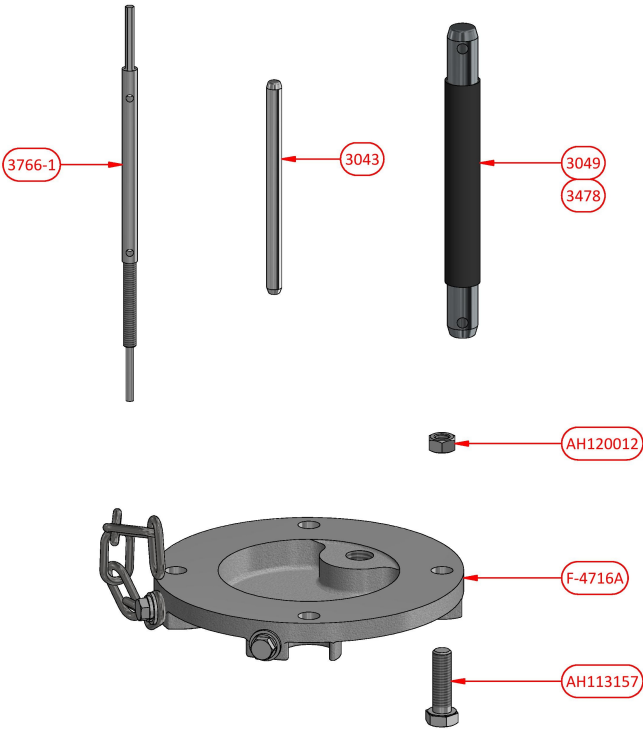

**Compliance**  
**Materials**

Non Hazardous Area Only. Dimensions to AS/NZS1300  
Aluminium / Silver Plated Copper

**CMI Head Office NSW** | (02) 9807 6155 | 18-20 Railway Road, Meadowbank NSW 2114 | [nswsales@cmielectrical.com.au](mailto:nswsales@cmielectrical.com.au)

**CMI QLD-Brisbane**  
(07) 3863 0749  
485A Zillmere Road,  
Zillmere QLD 4034  
[southqldsales@cmielectrical.com.au](mailto:southqldsales@cmielectrical.com.au)

**CMI QLD - Rockhampton**  
(07) 4921 0978  
Shop 3 at 76 Hollingsworth Street,  
North Rockhampton Qld 4701  
[northqldsales@cmielectrical.com.au](mailto:northqldsales@cmielectrical.com.au)

**CMI VIC**  
(03) 9532 1233  
3 Dissik Street,  
Cheltenham VIC 3192  
[vicsales@cmielectrical.com.au](mailto:vicsales@cmielectrical.com.au)

**CMI WA**  
(08) 9358 1788  
36 Division Street,  
Welshpool WA 6106  
[wasales@cmielectrical.com.au](mailto:wasales@cmielectrical.com.au)