



Gland Adaptor

F-4617-# #

300 Amp Series

Ordering Procedure

- 1
- Select complete Gland Adaptor from Table 1

Table 1

Part Number	Description
F-4617-25	Gland Adaptor (M25 entry thread)
F-4617-32	Gland Adaptor (M32 entry thread)
F-4617-40	Gland Adaptor (M40 entry thread)
F-4617-50	Gland Adaptor (M50 entry thread)
F-4617-63	Gland Adaptor (M63 entry thread)
F-4617-75	Gland Adaptor (M75 entry thread)
F-4617-85	Gland Adaptor (M85 entry thread)
F-4617-95	Gland Adaptor (M95 entry thread)
F-4617-110	Gland Adaptor (M110 entry thread)

Spare Parts

#	Part Number	Description
1	AI019010	O-ring ID 120.24 x sect. 3.53
2	201-264-3	Earth Strap
3	AH113091	Screw M8 x 10 hex. head
4	AH009363	Spring Washer 5/16"
5	AH009277	Washer 5/16"
6	AH151038	Screw M12 x 60 hex. head
7	AH120012	Nut M12

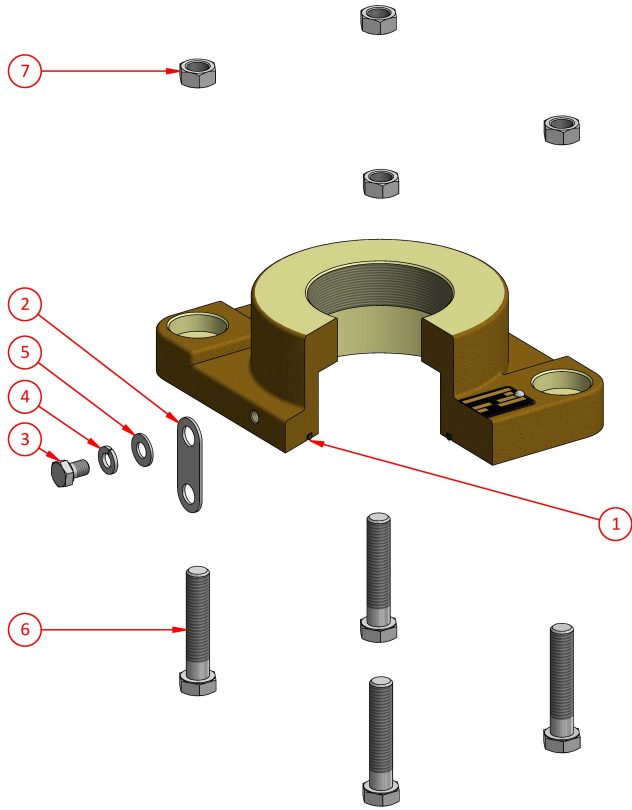

Weight

Dimensions

Compliance

Materials

IP Rating

7kg

L 220mm W 180mm H 80mm

Explosion protected to AS/NZS1299 & IEC60079 Series

Manganese Bronze

IP66/68

CMI Head Office NSW

CMI QLD-Brisbane

(07) 3063 0749

485A Zillmere Road,

Zillmere QLD 4034

southqldsales@cmielectrical.com.au

CMI QLD - Rockhampton

(07) 4921 0978

Shop 3 at 76 Hollingsworth Street,

North Rockhampton Qld 4701

northqldsales@cmielectrical.com.au

CMI VIC

(03) 9532 1233

3 Dissik Street,

Cheltenham VIC 3192

vicsales@cmielectrical.com.au

CMI WA

(08) 9358 1788

36 Division Street,

Welshpool WA 6106

wasales@cmielectrical.com.au