

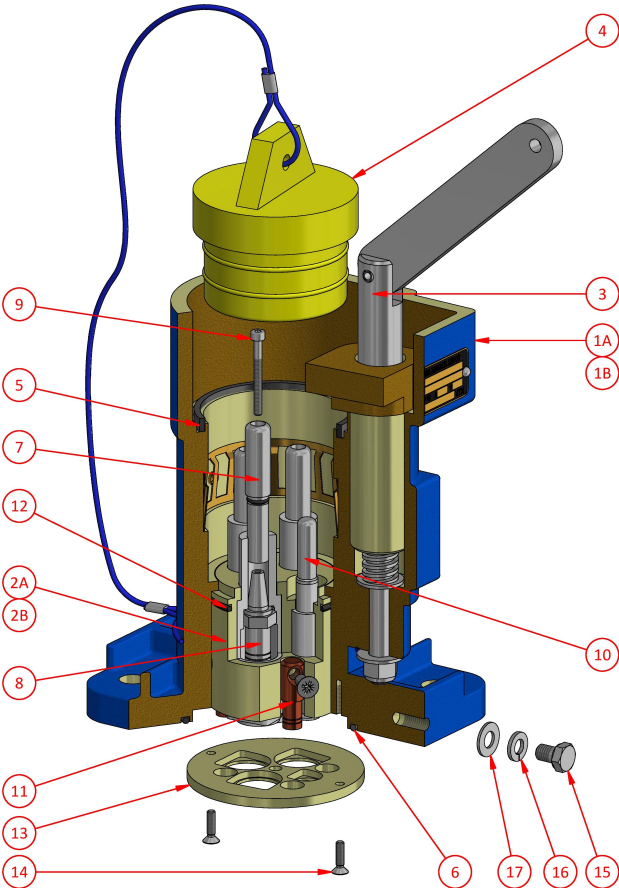

Receptacle
AG164B - AG114B

150 Amp Series
660V - 1100V



Weight
Dimensions
Compliance
Materials
IP Rating

13kg
L 180mm W 140mm H 320mm
Explosion protected to AS/NZS1299 & IEC60079 Series
Manganese Bronze / Brass / PTFE
IP66/68

Ordering Procedure

- 1

Select complete Receptacle from Table 1
- 2

Select Phase Thimble from Table 2 (3 Required)

Table 1

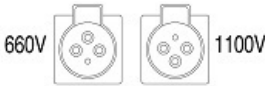

| Part Number | Description | Colour |
|-------------|-----------------------------|--------|
| AG164B | 660V Restrained Receptacle | Orange |
| AG114B | 1100V Restrained Receptacle | Blue |

NB: Receptacle supplied with Pilot Thimble

Table 2

| Phase Thimble - c/w screw AH151021 M4 x 40 skt. head | | | |
|--|-----|-------|----------------|
| Part Number | CSA | ID mm | Utilux Die No. |
| F-4626 | 6 | 3.7 | 38-44 Cu |
| F-4626-0 | 16 | 5.5 | 38-63 Cu |
| F-4626-1 | 25 | 7.1 | 38-77 Cu |
| F-4626-2 | 35 | 8.4 | 38-92 Cu |
| F-4626-3 | 50 | 9.5 | 38-104 Cu |
| F-4626-4 | 70 | 11.2 | 38-115 Cu |
| F-4626-5 | 95 | 13.4 | 38-142 Cu |

NB: CSA is indicative only. Use ID for final selection

Options

| Earth Thimble - c/w screw AH151037 M6 x 12 csk. head | | | |
|--|---------------------|-------|----------------|
| Part Number | Cable Acceptance mm | ID mm | Utilux Die No. |
| F-4648S | 10 | 4.7 | 38-57 Cu |
| F-4648-1S | 16 | 5.5 | 38-63 Cu |
| F-4648-2S | 25 | 7.1 | 38-77 Cu |
| F-4648-3S | 35 | 8.4 | 38-92 Cu |
| F-4648-4S | 50 | 10.0 | Solder Only |

NB: F-4648-2S supplied with Receptacle

Spare Parts

| # | Part Number | Description |
|----|-------------|--|
| 1A | F-3184-164 | 660V Receptacle Body c/w items 1A, 3, 5, 6, 15, 16 & 17 |
| 1B | F-3184-114 | 1100V Receptacle Body c/w items 1B, 3, 5, 6, 15, 16 & 17 |
| 2A | F-4621 | Interior c/w O-Ring, Earth Thimble, Retaining Plate & Screws |
| 2B | F-4621KIT | Interior Service Kit c/w O-Rings, Insulators, Pilot Pin Assy, Retaining Plate & Screws |
| 3 | 3401B | Jacking Screw |
| 4 | F-310 | Sealing Plug |
| 5 | 4401-2 | Seal |
| 6 | AI019011 | O-ring ID 91.67 x sect. 3.53 |
| 7 | F-4623 | Phase Pin c/w O-ring AI019001 |
| 8 | See Table 2 | Phase Thimble |
| 9 | AH151021 | Screw M4 x 40 skt. head |
| 10 | F-854 | Pilot Pin & Thimble Assembly c/w Insulator |
| 11 | F-4648-2S | Earth Thimble c/w screw AH151037 M6 x 12 csk. head |
| 12 | AI019003 | O-ring ID 63.17 x sect. 2.62 |
| 13 | 4628 | Interior Retaining Plate |
| 14 | AH151022 | Screw M4 x 16 csk. head |
| 15 | AH113091 | Screw M8 x 10 hex. head |
| 16 | AH009363 | Spring Washer 5/16" |
| 17 | AH009277 | Washer 5/16" |

CMI Head Office NSW | (02) 9807 6155 | 18-20 Railway Road, Meadowbank NSW 2114 | nswsales@cmielectrical.com.au
CMI QLD-Brisbane
(07) 3863 0749
485A Zillmere Road,
Zillmere QLD 4034
southqldsales@cmielectrical.com.au

CMI QLD - Rockhampton
(07) 4921 0978
Shop 3 at 76 Hollingsworth Street,
North Rockhampton Qld 4701
northqldsales@cmielectrical.com.au

CMI VIC
(03) 9532 1233
3 Dissik Street,
Cheltenham VIC 3192
vicsales@cmielectrical.com.au

CMI WA
(08) 9358 1788
36 Division Street,
Welshpool WA 6106
wasales@cmielectrical.com.au