

Ordering Procedure

- 1
- Select complete Accessory from Table 1

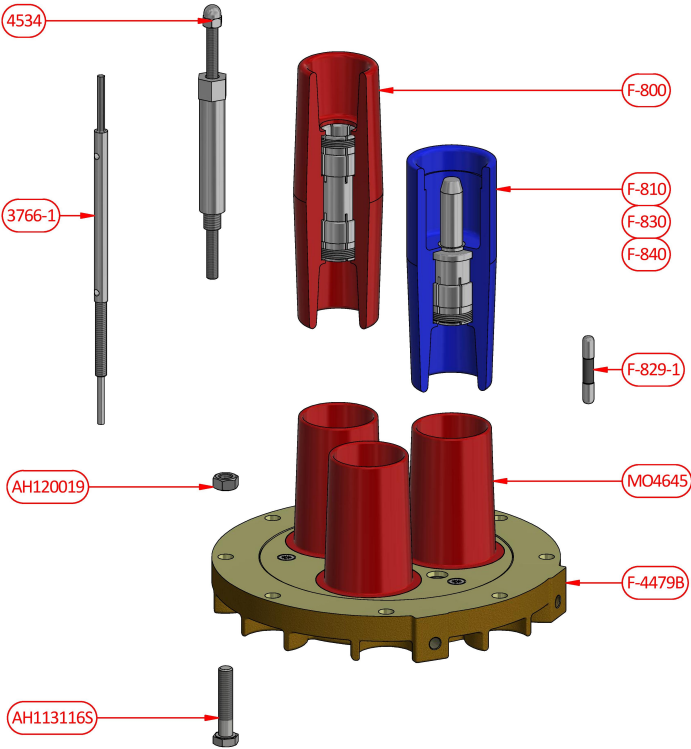

Table 1

Part Number	Description
F-4479B	800A Blanking Cover
F-829-1	800A Pilot Connecting Pin
F-800	800A Phase Connecting Socket
F-810	800-150A Phase Transition Connecting Pin
F-830	800-300A Phase Transition Connecting Pin
F-840	800-425A Phase Transition Connecting Pin
3766-1	Socket Extraction Tool
4534	800A Connecting Socket Extraction Tool
AH113116S	Screw M10 x 50 hex. head
AH120019	M10 Nut
MO4645	Blanking Cover Insulator

Compliance
Materials

Explosion protected to AS/NZS1300 & IEC60079 Series
Manganese Bronze / Silicone Rubber / Silver Plated Copper

CMI Head Office NSW | (02) 9807 6155 | 18-20 Railway Road, Meadowbank NSW 2114 | nswsales@cmielectrical.com.au
CMI QLD-Brisbane
(07) 3863 0749
485A Zillmere Road,
Zillmere QLD 4034
southqldsales@cmielectrical.com.au

CMI QLD - Rockhampton
(07) 4921 0978
Shop 3 at 76 Hollingsworth Street,
North Rockhampton Qld 4701
northqldsales@cmielectrical.com.au

CMI VIC
(03) 9532 1233
3 Dissik Street,
Cheltenham VIC 3192
vicsales@cmielectrical.com.au

CMI WA
(08) 9358 1788
36 Division Street,
Welshpool WA 6106
wasales@cmielectrical.com.au