

Bolted Coupler
AA364S - AA314S
AA464S - AA414S

300/425 Amp Series B

Body Size B - 660V - 1100V

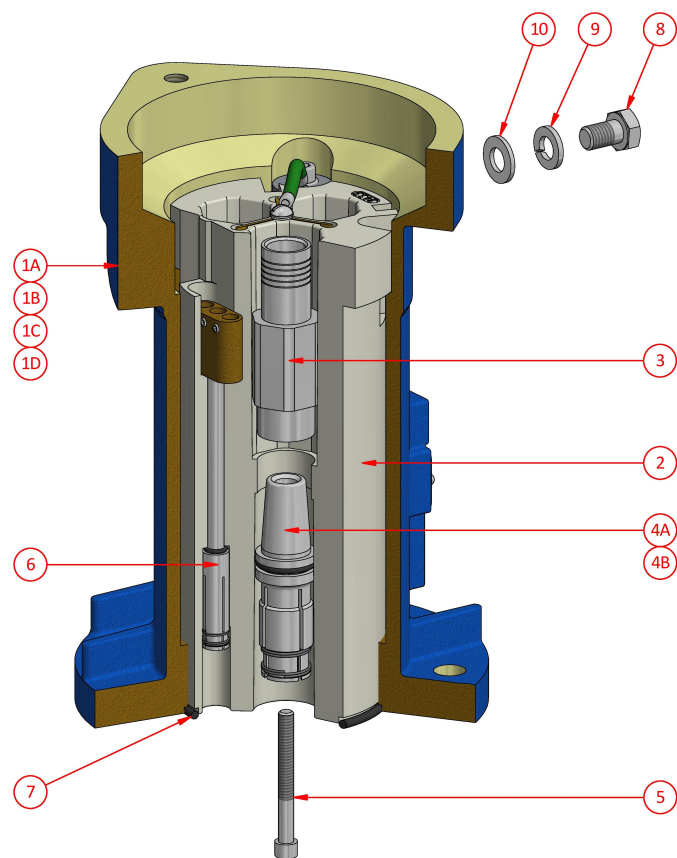

Weight 12.0kg
Dimensions L 200mm W 210mm H 280mm
Compliance Explosion protected to IEC60079 Series
Materials Manganese Bronze / Polyester
IP Rating IP66

Ordering Procedure

- 1** Select complete Coupler from Table 1
- 2** Select Phase Thimble from Table 2 (3 Required)
- 3** Select Gland from No.2 to No.5 Glands
- 4** Select Accessories from Body Size B Accessories

Table 1

Part Number	Description	Colour
AA364S	300A 660V Bolted Coupler	Orange
AA314S	300A 1100V Bolted Coupler	Blue
AA464S	425A 660V Bolted Coupler	Orange/Silver
AA414S	425A 1100V Bolted Coupler	Blue/Silver

NB: Coupler supplied with Pilot Thimble

Table 2

Phase Thimble - c/w screw AH009868 1/4" x 2 1/4" skt. head

Part Number	CSA	ID mm	Utilux Die No.
F-201-432	25	8.0	38-92 Cu
F-201-302	35	9.5	38-115 Cu
F-201-303	50	10.5	38-115 Cu
F-201-303-1	70	12.8	38-142 Cu
F-201-304-1	95	14.0	38-165 Cu
F-201-305-1	120	16.0	38-165 Cu
F-201-306-1	150	18.0	38-183 Cu
F-201-307-1	185	21.8	SOLDER ONLY
F-201-326-1	240	24.2	SOLDER ONLY

NB: CSA is indicative only. Use ID for thimble selection

Spare Parts

#	Part Number	Description
1A	F-3432-364	300A 660V Coupler Body c/w items 1A, 7, 8, 9 & 10
1B	F-3432-314	300A 1100V Coupler Body c/w items 1B, 7, 8, 9 & 10
1C	F-3432-464	425A 660V Coupler Body c/w items 1C, 7, 8, 9 & 10
1D	F-3432-414	425A 1100V Coupler Body c/w items 1D, 7, 8, 9 & 10
2	F-3433-2	Interior c/w Strap, Screw & Washer
3	See Table 2	Phase Thimble
4A	F-201-299	300A Phase Socket
4B	F-201-300-1	425A Phase Socket
5	AH009868	Screw 1/4" x 2 1/4" skt. head
6	F-3874	Pilot Socket c/w Pilot Thimble
7	AI019006	O-ring ID 82.14 x sect. 3.53
8	AH113111	Screw M10 x 16 hex. head
9	AH151011	Spring Washer M10
10	AH150011	Washer M10

CMi Head Office NSW | (02) 9807 6155 | 18-20 Railway Road, Meadowbank NSW 2114 | nswsales@cmielectrical.com.au
CMi QLD-Brisbane
(07) 3863 0749
485A Zillmere Road,
Zillmere QLD 4034
southqldsals@cmielectrical.com.au

CMi QLD - Rockhampton
(07) 4921 0978
Shop 3 at 76 Hollingsworth Street,
North Rockhampton Qld 4701
northqldsals@cmielectrical.com.au

CMi VIC
(03) 9532 1233
3 Dissik Street,
Cheltenham VIC 3192
vicsales@cmielectrical.com.au

CMi WA
(08) 9358 1788
36 Division Street,
Welshpool WA 6106
wasales@cmielectrical.com.au