



Gland Adaptor

F-4629-# #

150 Amp Series

Ordering Procedure

- 1

Select complete Gland Adaptor from Table 1

Table 1

Part Number	Description
F-4629-20	Gland Adaptor (M20 entry thread)
F-4629-25	Gland Adaptor (M25 entry thread)
F-4629-32	Gland Adaptor (M32 entry thread)
F-4629-40	Gland Adaptor (M40 entry thread)
F-4629-50	Gland Adaptor (M50 entry thread)
F-4629-63	Gland Adaptor (M63 entry thread)

Spare Parts

#	Part Number	Description
1	AI019011	O-ring ID 91.67 x sect. 3.53
2	201-264-3	Earth Strap
3	AH113091	Screw M8 x 10 hex. head
4	AH009363	Spring Washer 5/16"
5	AH009277	Washer 5/16"
6	AH151038	Screw M12 x 60 hex. head
7	AH120012	Nut M12

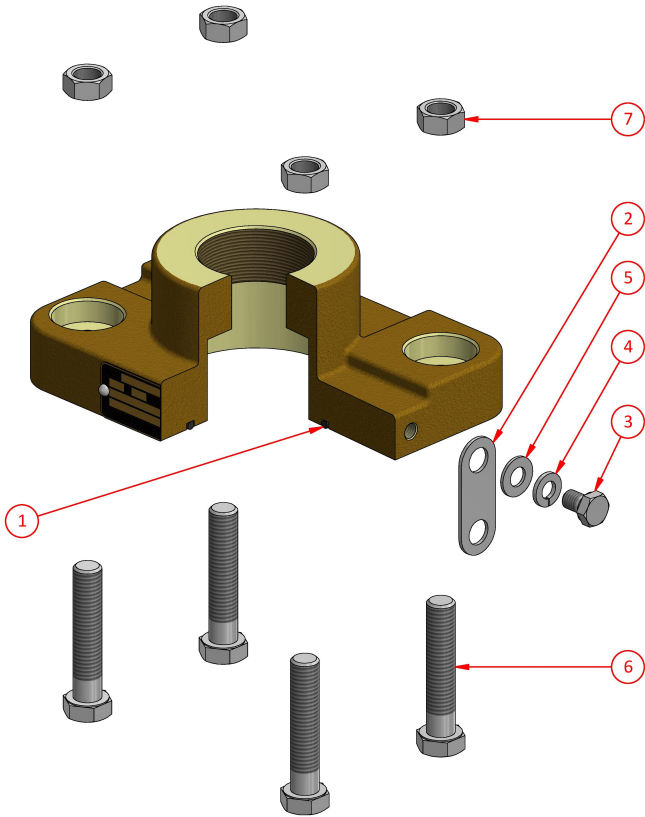

Weight

Dimensions

Compliance

Materials

IP Rating

6kg

L 170mm W 130mm H 70mm

Explosion protected to AS/NZS1299 & IEC60079 Series

Manganese Bronze

IP66/68

CMi Head Office NSW

CMi QLD-Brisbane

(07) 3863 0749

485A Zillmere Road,

Zillmere QLD 4034

southqldsales@cmielectrical.com.au

(02) 9807 6155

| 18-20 Railway Road,

Meadowbank NSW 2114

| nswsales@cmielectrical.com.au

CMi QLD - Rockhampton

(07) 4921 0978

Shop 3 at 76 Hollingsworth Street,

North Rockhampton Qld 4701

northqldsales@cmielectrical.com.au

CMi VIC

(03) 9532 1233

3 Dissik Street,

Cheltenham VIC 3192

vicsales@cmielectrical.com.au

CMi WA

(08) 9358 1788

36 Division Street,

Welshpool WA 6106

wasales@cmielectrical.com.au